

DIRECTIONS

Stainless Steel Cable & Clearline Hangers

NOTE: Both Stainless Steel Cable and Clearline Hangers are fitted in the same manner.

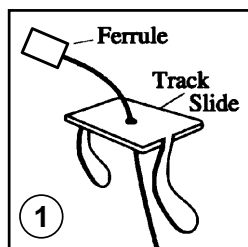

1. Feed the hanger through the track slide (see Fig 1).

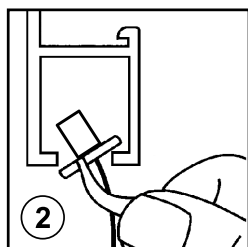

2. Tilt the track slide to insert into the underside of the track (can be fitted at any point along the track).

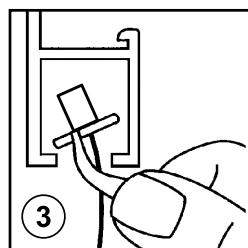

3. Straighten the track slide so it sits level in the track.

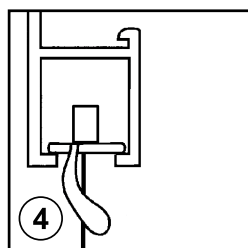

4. The hanger is now secure and ready for the adjustable hook to be fitted.

RECOMMENDED WEIGHT:

See The Gallery System Weight Guide on page 5 for maximum weight specifications and compatibility of hangers and hooks.